



Photo: KTR

Photo: KTR-V

Is mounted on inlets to compressed-air cleaned filter units to prevent backdraft to channel in connection with compressed-air cleaning of filters. Used for dusty air, but not chips and the like.

Available in two versions for low and high pressure respectively.

Vacuum: Up to 5,000Pa (low pressure)
or 40,000Pa (high pressure)

Channel velocity: Max. 25 m/s

Pressure drop: 350-600Pa

Description

- Backdraft damper type KTR is constructed as a louvre grid with two connections. Do not seal 100% .

Konstruktion/surface:

Damper is made in 2mm black steel plate

Surface powder enamelled RAL 7011 structure

Backdraft damper type KTR is available in the sizes as stated in the forms below.

Please, contact us for assistance in selecting the optimal size.

Backdraft damper type KTR for low pressure (max. 5,000Pa):

Type	Order no.	Connection Inlet/outlet ¹⁾ [mm]	Weight [kg]
KTR 160	06 850 100	ø160	8
KTR 200	06 850 300	ø200	12
KTR 250	06 850 000	ø250	15
KTR 315	06 850 200	ø315	14
KTR 400	06 850 400	ø400	23
KTR 500	06 850 600	ø500	22
KTR 630	06 850 800	ø630	25

¹⁾ Nipple measurement

Backdraft damper type KTR-V for high pressure (max. 40,000Pa):

Type	Order no.	Connection Inlet/outlet [mm]	Weight [kg]
KTR-V 108 ¹⁾	06 849 000	ø108	5
KTR-V 127 ¹⁾	06 849 100	ø127	5
KTR-V 152 ¹⁾	06 849 200	ø152	8
KTR-V 203 ¹⁾	06 849 300	ø203	8
KTR-V 250 ²⁾	06 849 400	ø250	16
KTR-V 315 ²⁾	06 849 500	ø315	16
KTR-V 400 ²⁾	06 849 600	ø400	26

¹⁾ For sealing clamp type HRK

²⁾ With JKF flange

Backdraft damper type KTR for low pressure (max. 5,000Pa):

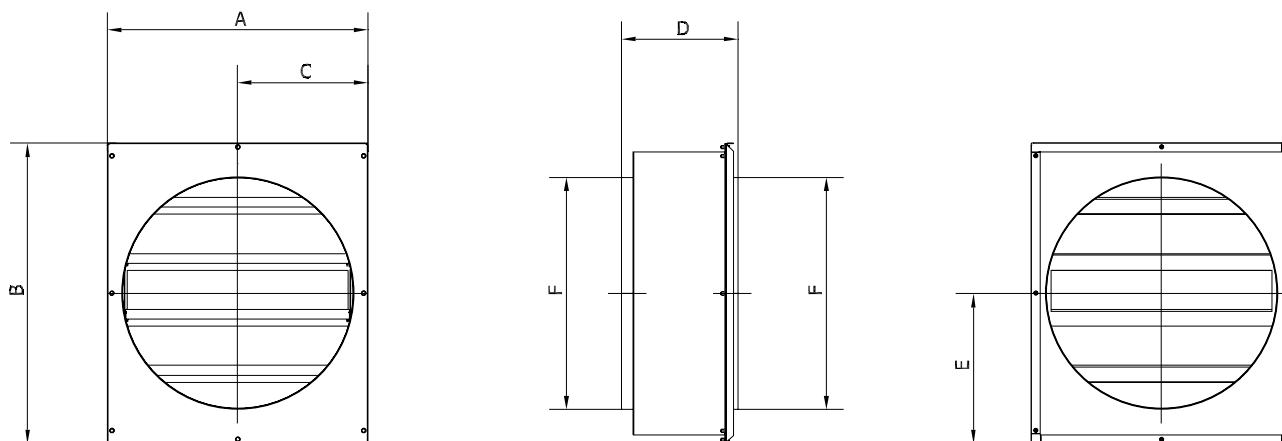

Type	Order no.	A	B	C	D	E	F
KTR 160	06 850 100	264	352	132	315	176	ø160
KTR 200	06 850 300	264	352	132	315	176	ø200
KTR 250	06 850 000	421	504	211	315	252	ø250
KTR 315	06 850 200	421	504	211	315	252	ø315
KTR 400	06 850 400	606	663	303	315	332	ø400
KTR 500	06 850 600	606	663	303	333	332	ø500
KTR 630	06 850 800	706	816	353	315	408	ø630

Backdraft damper type KTR-V for high pressure (max. 40,000Pa):

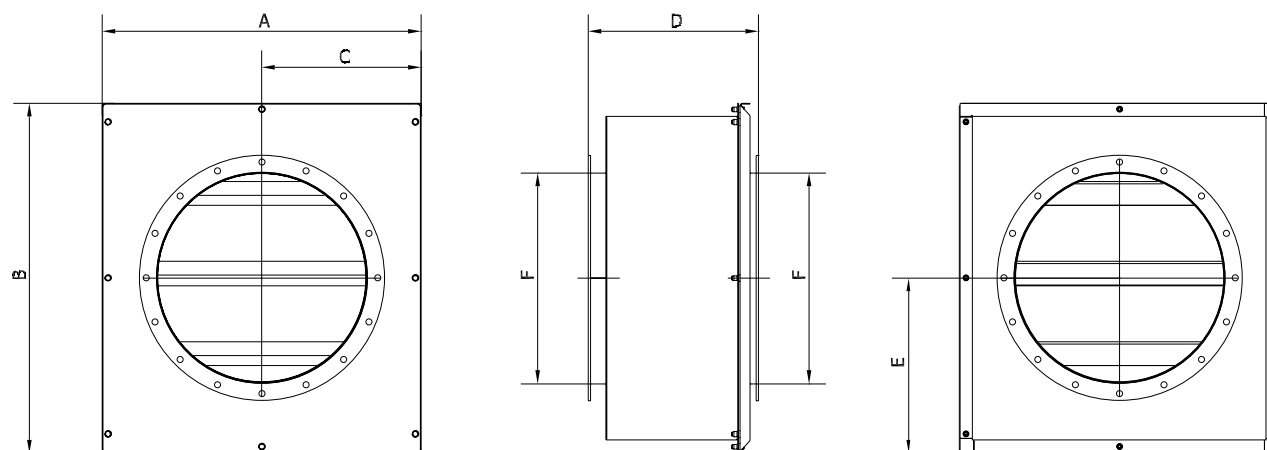

Type	Order no.	A	B	C	D	E	F
KTR-V 108	06 849 000	264	207	132	280	103	ø108
KTR-V 127	06 849 100	264	207	132	280	103	ø127
KTR-V 152	06 849 200	264	352	132	315	176	ø152
KTR-V 203	06 849 300	264	352	132	315	176	ø203
KTR-V 250	06 849 400	421	504	211	323	252	ø250
KTR-V 315	06 849 500	421	504	211	323	252	ø315
KTR-V 400	06 849 600	606	663	303	323	332	ø400

Rev. 01.20 Data is subject to alterations